

Foothills 76'

3 beds / 2 baths / 1,165 sq. ft. / 16x76

Foothills
SERIES

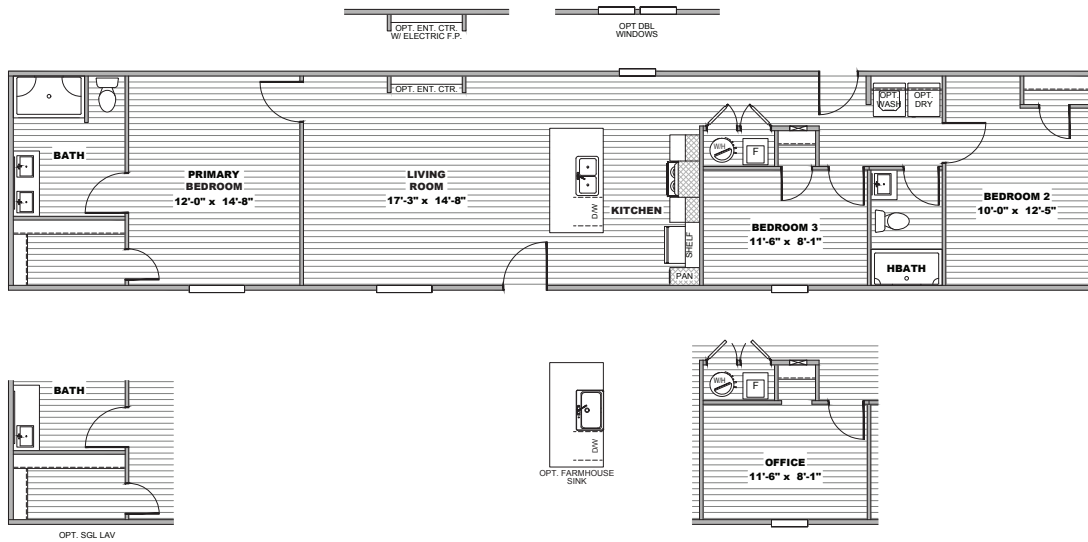

Maynardville standards

- Shaw® vinyl flooring throughout
- GAF® architectural shingles
- 6-panel steel front door with storm
- 6-light cottage rear door with storm
- Lined overhead cabinets
- 1-piece fiberglass hall bath tub/shower
- Fiberglass tubs and showers in baths
- Porcelain lavatories - double sink standard in primary bath
- Front exterior faucet

Available upgrades

Room upgrades

- Double windows in the dining room
- Entertainment center with or without electric fireplace
- Single sink option in primary bath

Exterior upgrades

- Rear exterior faucet
- Hitch end elevation options
- Craftsman front door with storm door
- OSB exterior wrap

Interior upgrades

- Water cutoffs throughout
- Cabinet above refrigerator
- Stainless steel farmhouse sink with pull-down sprayer
- Stainless steel side-by-side refrigerator
- Rangehood microwave

Customer Name _____

Customer County/State _____

Customer Email _____

Customer Signature _____



View model online

eBuilt

The home series, floor plans, photos, renderings, specifications, features, materials and availability shown will vary by location, and are subject to change without notice.

Clayton
maynardville